

Two shots and over molding mould

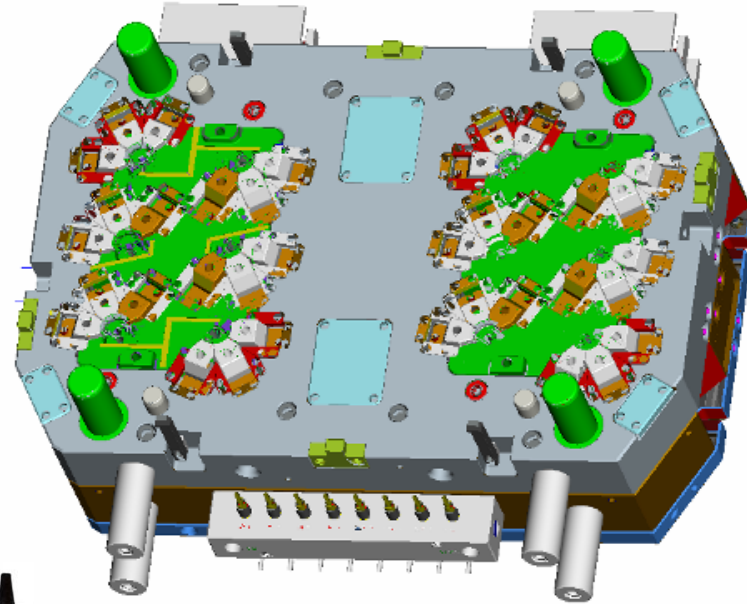

Characteristics

- Angled barrels;
- Rotate whole rear unit;
- PC/ABS + TPE;
- Synventive 12 drops HF
- Floating B plate.



Rotatable Core Half

- **Parallel barrels;**
- **Rotate the whole rear unit;**
- **ABS.GF16 + PMMA;**
- **Moldmaster HRS;**
- **High Gloss polishing.**



X7 B Pillar Outer

- **Parallel barrels;**
- **Rotate floating core;**
- **ABS + TPE;**
- **Multi-drops HRS.**

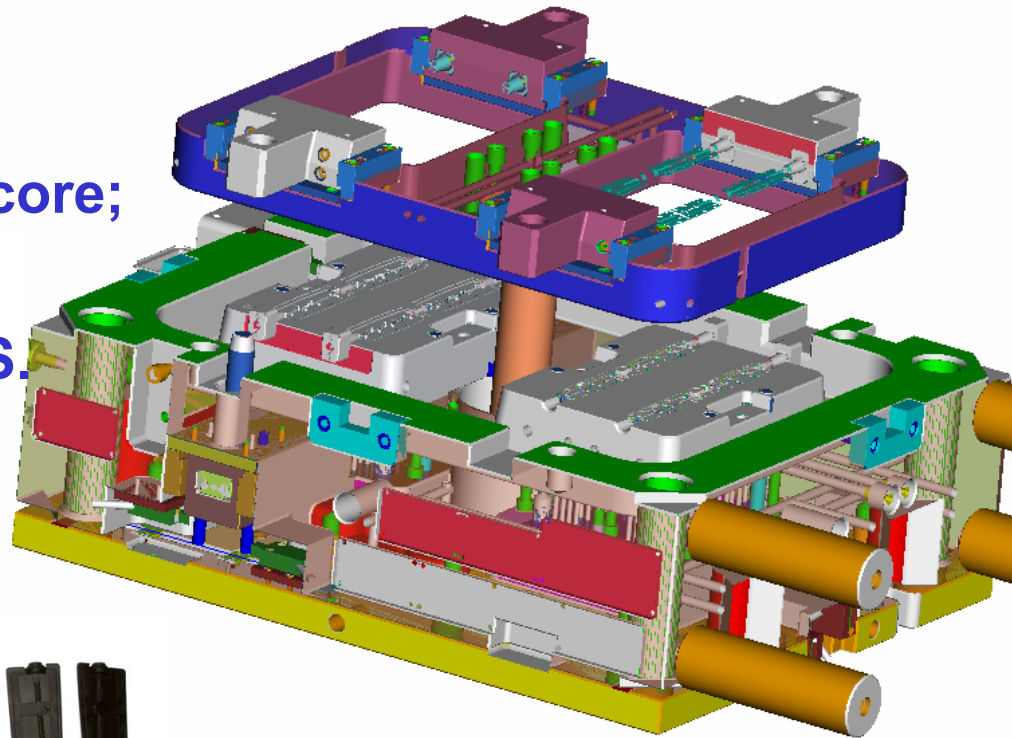

Self-rotatable Core Half

- **Vertical barrels;**
- **In-mold rotation unit;**
- **PC/ABS + PC;**
- **Cold runner.**

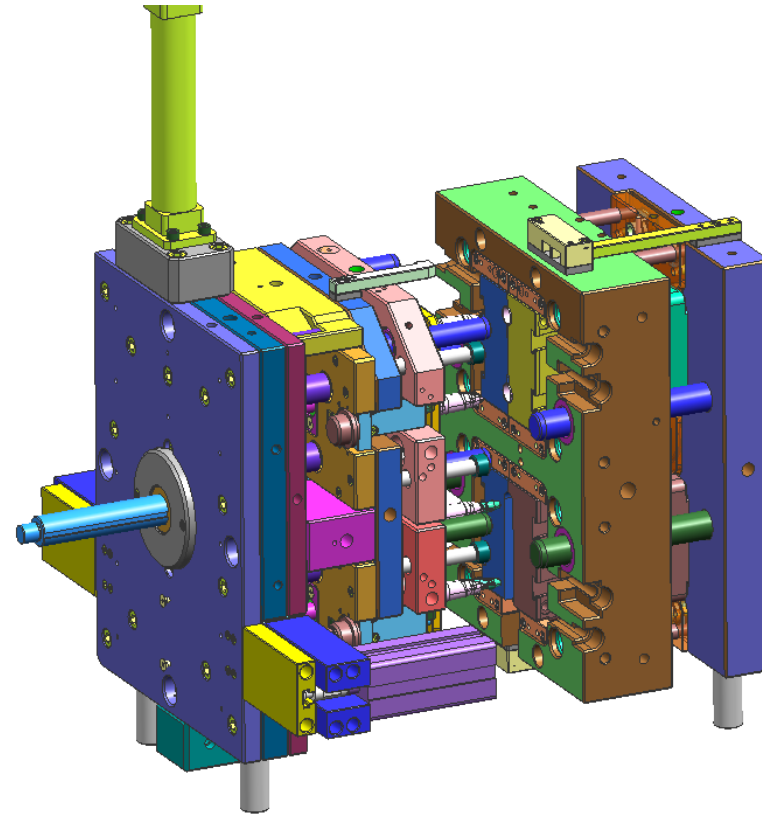

- **Vertical barrels;**
- **Shuttle core;**
- **ABS + TPE;**
- **Cold runner+ hot drop.**

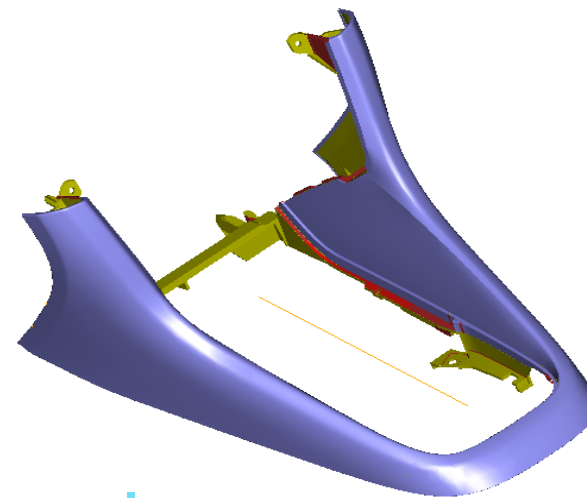
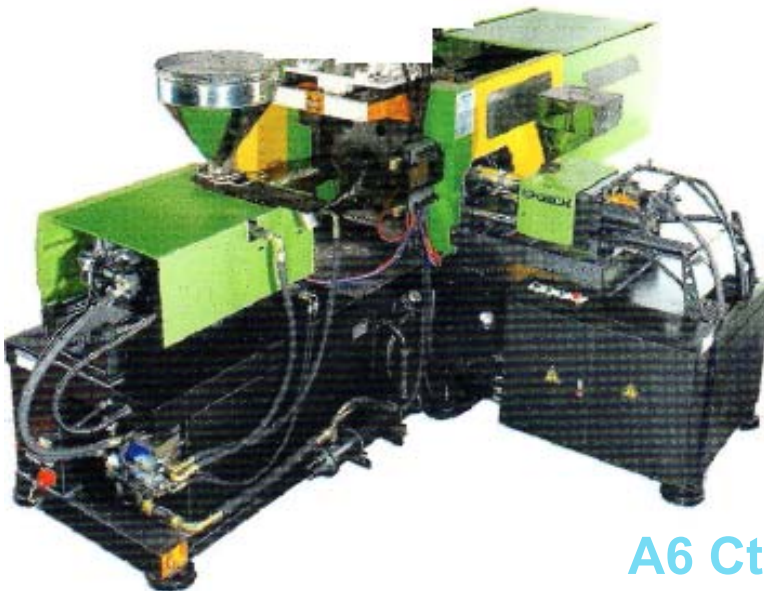
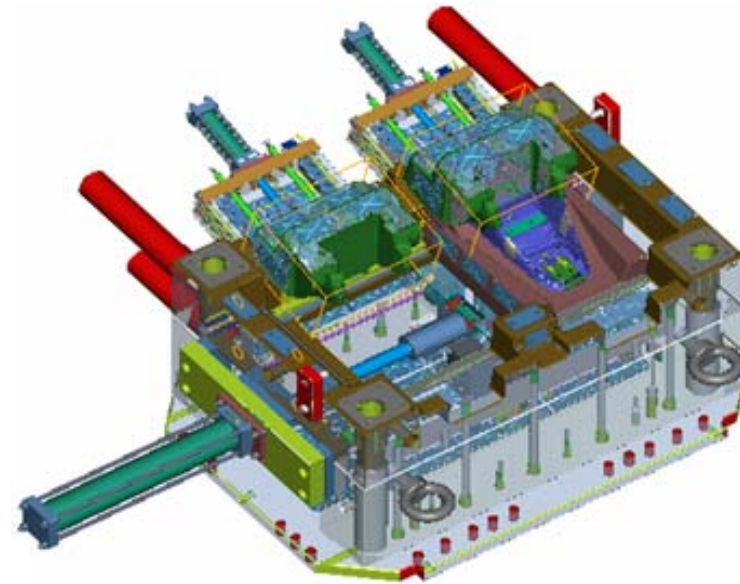

A6 Ctr. Console

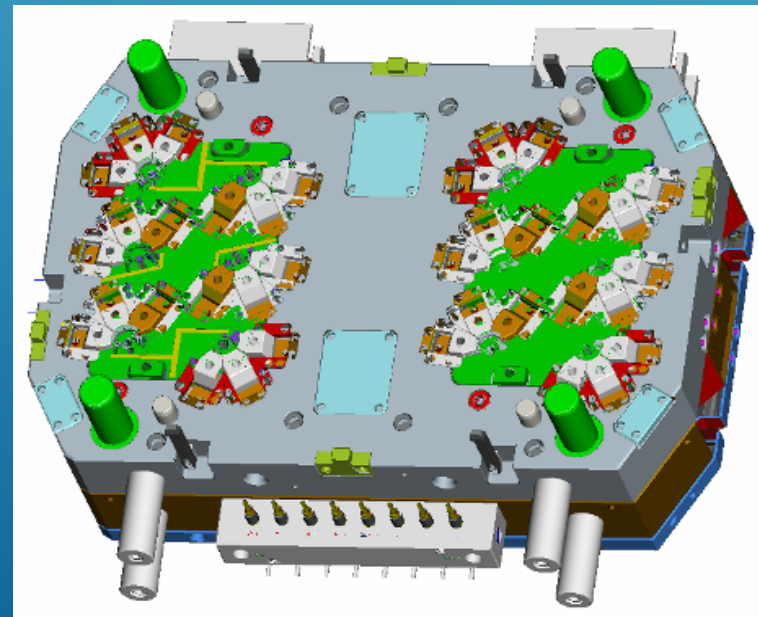
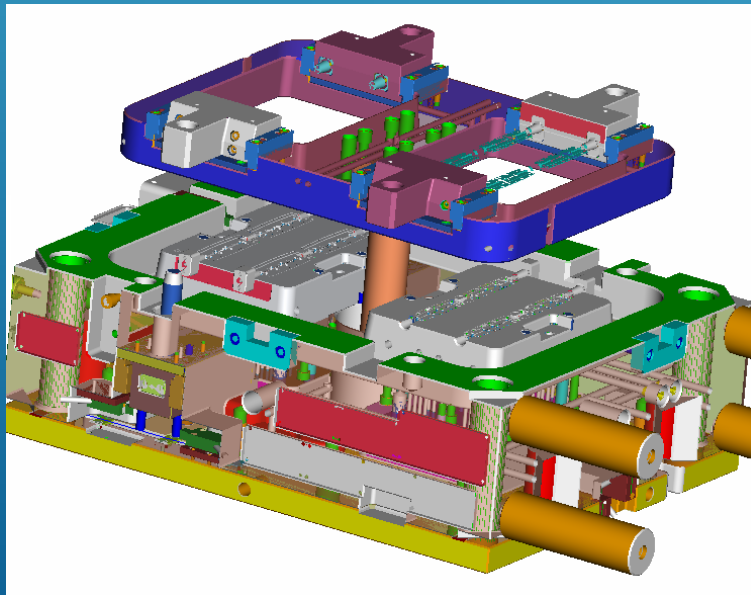
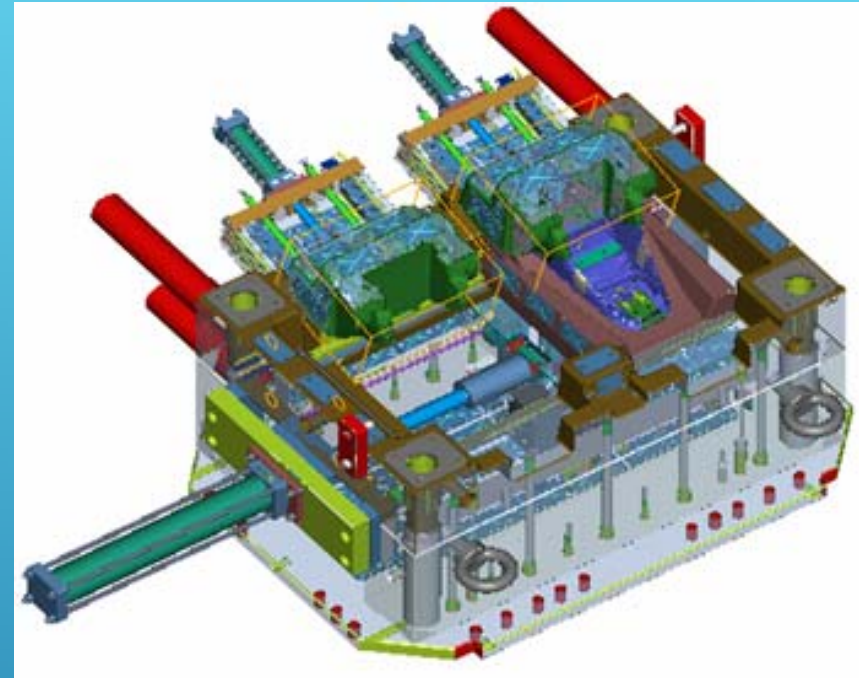
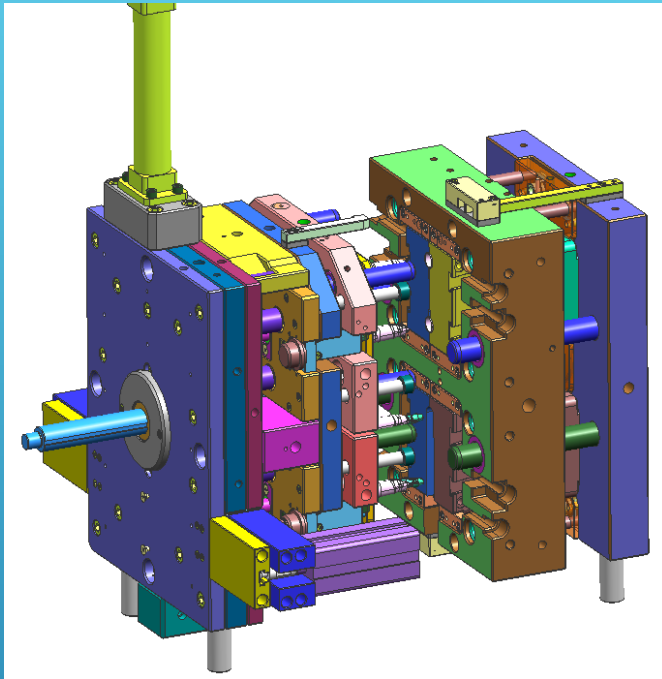

- In-mold Decoration;
- Over-mold Process;
- PC/ABS + Appliqué;



P150 PRNDL Bezel



DS09 Ctr. Bezel